

PBA, ROHM, & SMW CHUCKS
MODELS PRATT BURNERD, ROHM, SMW
SELF-CONTAINED AIR CHUCKS
1/16" x 90° SERRATED

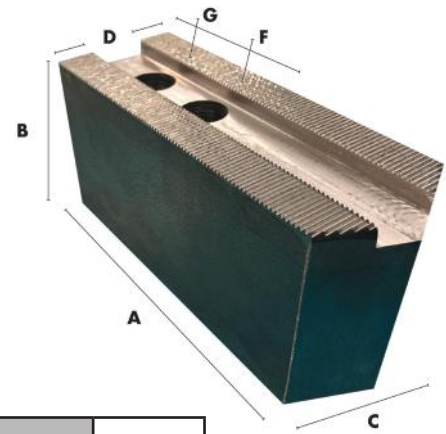

SOFT JAWS

CRITICAL

chuck size (inches)	part number	A	B	C	D	F	SCREW SIZE	G
6.5	6.5SMW	3.00	1.50	1.50	0.551	0.984	3/8	1.00
6.5	*6.5SMWOP	3.50	1.50	1.50	0.551	0.875	3/8	0.50
8	8.1SMW	3.50	2.00	1.50	0.669	1	1/2	0.75
8	*8.1SMWOP	4.13	2.00	1.50	0.669	1	1/2	0.50
10-12.5	+12.5LSMW	5.25	2.50	2.00	0.827	1.187	1/2	0.62
10-12.5	*12.5LSMWOP	5.25	2.50	2.00	0.827	1.187	1/2	0.62
12.5	+12.5LSMW58	5.25	2.50	2.00	0.827	1.187	5/8	0.62
12.5	*12.5LSMW58OP	5.25	2.50	2.00	0.827	1.187	5/8	0.62
16**	16SMW	6.25	3.00	2.50	1.001	1.563	3/4	1.44
16**	*16SMWOP	8.00	3.00	2.50	1.001	1.563	3/4	1.38

* POINTED 3-HOLE STYLE. ALL OTHERS ARE SQUARE 2-HOLE STYLE.
** 3/32 X 90 DEGREE SERRATIONS
+3 HOLES SQUARE

*** ALUMINUM JAWS, T-NUTS AVAILABLE FROM STOCK!**
*** HARD JAWS SPECIALLY QUOTED!**

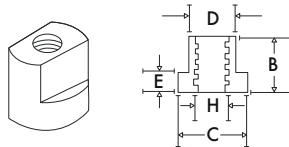

"T" NUTS FOR SMW

chuck size (inches)	part number	A	B	C	D	E	SCREW SIZE
10-12	DTNSMW12.5	N/A	1.17	1.10	.826	.42	1/2-13
10-12	DTNSMW58	N/A	1.17	1.10	.826	.42	5/8-11
16-20	DTNSMW16	N/A	1.34	1.34	.999	.57	3/4-10

STANDARD HEIGHT

CRITICAL

EXTRA HEIGHT

chuck size (inches)	part number	A	B	D	F	SCREW SIZE	part number	B
8	HOW12MA8P	8.00	2.00	0.669	0.984	1/2	HOW12MA8P1	4.00
10	SMW10P	10.00	2.00	0.827	1.187	5/8	SMW10P1	4.00
12	SMW12P	12.00	2.00	0.827	1.187	5/8	SMW12P1	4.00

FOR CAST IRON ADD "CI" TO THE BEGINNING OF THE ALUMINUM PART NUMBER. OTHER SIZES AVAILABLE.